



Product range 2016/17





## Dimensions

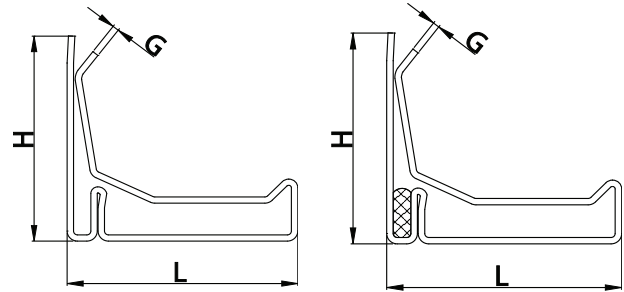

Profile DF

Profile DF-SIL with seal

## Description

The DF profile is made of galvanized steel sheet and is used for connecting rectangular ventilation ducts. It is mounted directly on the end of a duct and a fitting.

Depending on dimensions of a duct and air pressure inside a duct three dimensions of the profile may be used. The aluminium and acid-resistant steel profiles are always produced with a sealing specially designed for ventilation ducts. A range of working temperatures for a sealing is -30°C up to +100°C. Maximal momentary temperature to which the sealing may be subjected is +200°C. The sealing material is resistant to ageing, has a good adherence to a base, good mechanical stability and makes a good anti-corrosive protection.

Packing: 5 m long sections packed in 500 meters bundles, and 3 m long sections packed in 300 meters.

### Example identification

Product code: DF-C-20-ECO-SIL

material  
dimension  
version  
sealing

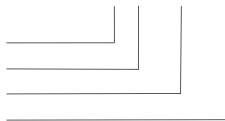

type	height H [mm]	width L [mm]	thickness G [mm]
DF-C-20	25	20	0,7
DF-C-30	25	30	0,8
DF-C-40	30	40	0,9
DF-C-20-SIL	25	20	0,7
DF-C-30-SIL	25	30	0,8
DF-C-40-SIL	30	40	0,9

pressure [Pa]	dimension of „a” or „b”				
	< 500 [mm]	500-1000 [mm]	1001-1600 [mm]	1601-2500 [mm]	2501 [mm]
200	DF20	DF20	DF30	DF30	DF40
400	DF20	DF20	DF30	DF30	DF40
600	DF20	DF20	DF30	DF30	DF40
800	DF20	DF20	DF30	DF30	DF40
1000	DF20	DF20	DF30	DF30	DF40
1200	DF20	DF30	DF30	DF40	DF40
1500	DF20	DF30	DF30	DF40	DF40



## Description

DF galvanised side corners are used to join DF20, 30 and 40 channels and thus create an end cover for connecting two rectangular ducts. The side corners can be made of acid-proof material or aluminium.

Example identification  
 Product code: DF-20-C  
 type \_\_\_\_\_  
 material \_\_\_\_\_

## Dimensions

Side Corner DF-C-20

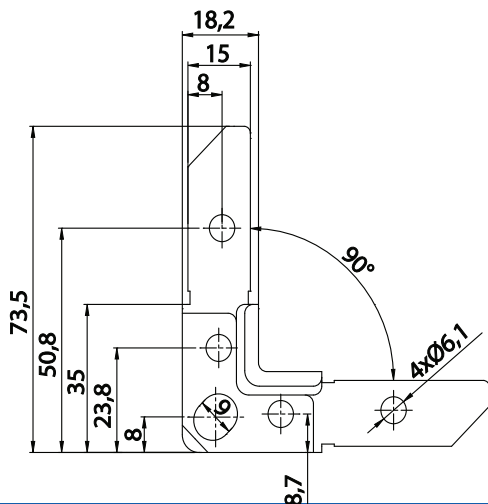

Side Corner DF-C-20K

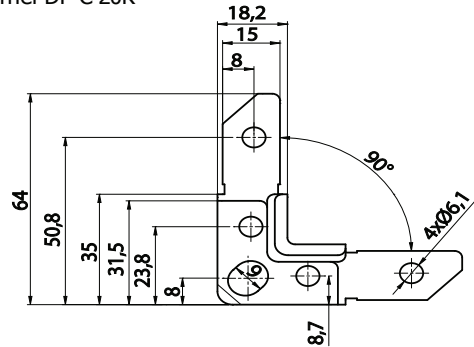

Side Corner DF-C-20L

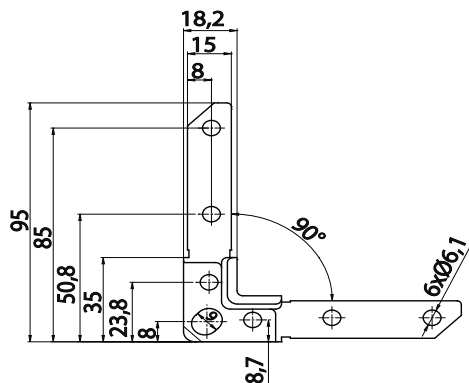

Side Corner DF-C-30

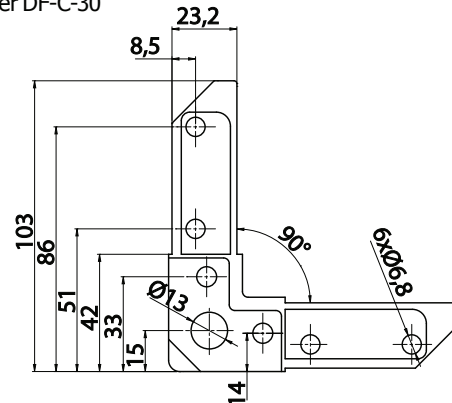

Side Corner DF-C-40

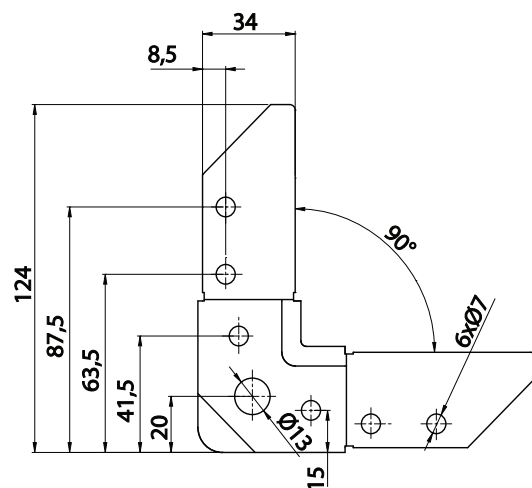



## Dimensions

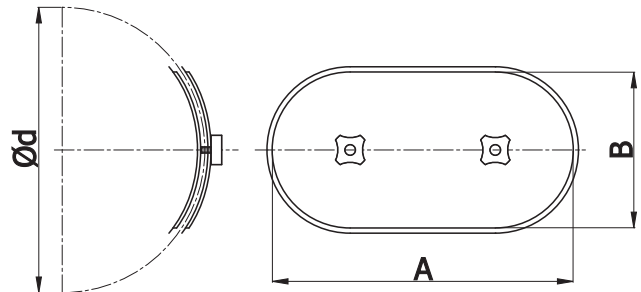

## Description

DFCA access door are equipped with CR EPDM gasket and designed for fitting onto round ducts. Its structure, together with adhesive gasket, makes an ideal alignment with a round duct surface. Hence a high class air tightness is guaranteed. It is a simple and effective yet a low cost method for closing inspection openings. Opening sizes are dependent on ducts diameters as per BS 12907 regulation. Another factor influencing an opening size is cleaning method - in some cases even an 800x400mm access door is required. To ensure an easy installation a self – adhesive cut-out template is included. After loosening the knobs, put the inner cover into the duct, adjust position and tighten the knobs.

## Available materials:

DFCA-...- galvanized steel

Example identification

Product code:                      DFCA    -    aaa

type \_\_\_\_\_  
 Ød        \_\_\_\_\_

Ød nom [mm]	A [mm]	B [mm]	weight [kg]	diameters range
80	180	80	0,3	76 -85
100	180	80	0,3	96-105
125	180	80	0,3	121-130
150	250	150	0,4	130-155
160	250	150	0,4	156-190
200	250	150	0,4	191-240
250	250	150	0,4	241-300
315	250	150	0,4	301-360
355	300	200	0,4	341-380
400	300	200	1,0	381-420
450	300	200	1,0	421-470
500	300	200	1,0	471-530
560	400	300	2,0	531-600
600	400	300	2,0	570-640
630	400	300	2,0	601-670
710	400	300	2,0	671-750
800	400	300	2,0	751-850

\* A and B - dimensions of the hole to be cut in the duct



## Dimensions

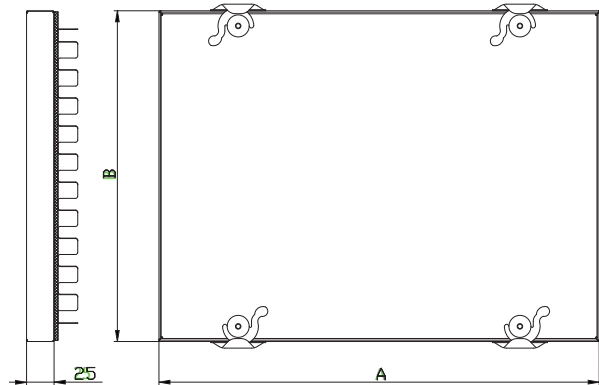

## Description

The DFTA access door to access and cleaning of rectangular ducts. The DFTA are made of galvanized steel and the door is additionally sealed with a rubber mat. It also has thermal insulation of glass mineral wool with a thickness of 25 mm. Four clasps allow easy opening and closing. This makes it possible to have a quick access to the ventilation system.

Example identification

Product code:                      DFTA   -   aaa

type \_\_\_\_\_  
 AxB \_\_\_\_\_

code	A [mm]	L [mm]
DFTA-150-150	150	150
DFTA-200-200	200	200
DFTA-300-300	300	300
DFTA-400-400	400	400
DFTA-450-450	450	450
DFTA-500-500	500	500
DFTA-600-600	600	600



## Description

DFPRQ guides are intended for installing turning vanes in rectangular fittings to direct the air flow. They are made of galvanised steel with rubber gasket. They are used for the installation of sheet metal with a thickness from 0.4 to 1.1mm.

Example identification

Product code: DFPRQ

type \_\_\_\_\_

Unlike the guides, the turning vanes are integrated with the fittings, and they are not available as separate products.

## Dimensions

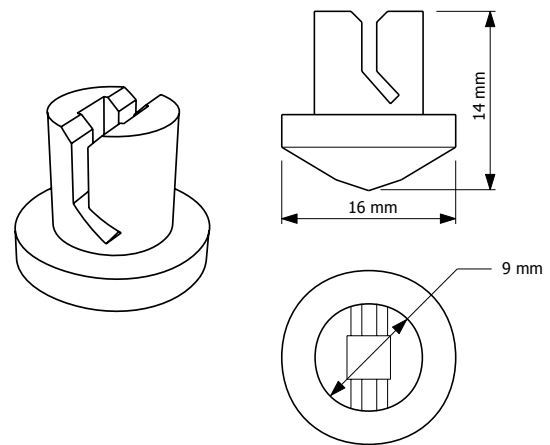

## Installation diagram

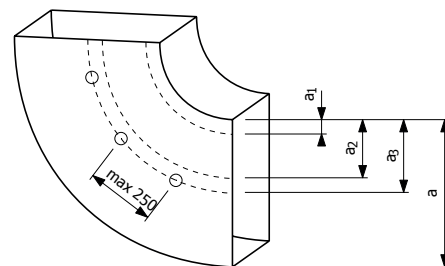

Bends layout of turning vanes

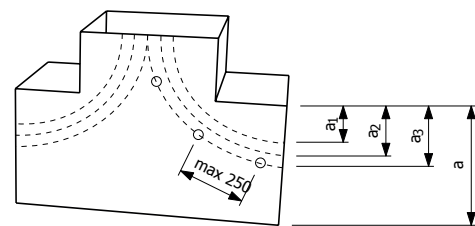

T-piece layout of turning vanes

duct width [mm]	number of vanes [pcs]	Distances between turning vanes		
		$a_1$	$a_2$	$a_3$
$> 400 \leq 800$	1	$a/3$	-	-
$> 800 \leq 1600$	2	$a/4$	$a/2$	-
$> 1600 \leq 2000$	3	$a/8$	$a/3$	$a/2$



## Description

The DFKLQ clamp is used to protect rectangular duct connections with joining profile end cover.

Example identification

Product code: DF KLQ-20

type

## Dimensions

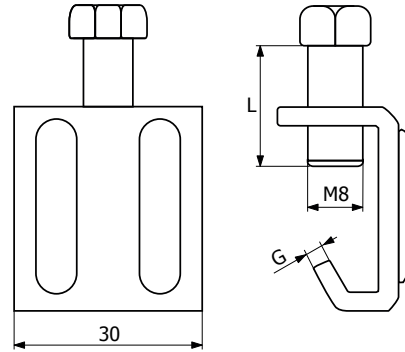

type	screw [mm]	L [mm]	G [mm]
DF KLQ-20	M8	25	3,0
DF KLQ-20-2,5	M8	20	2,5

## Connection method

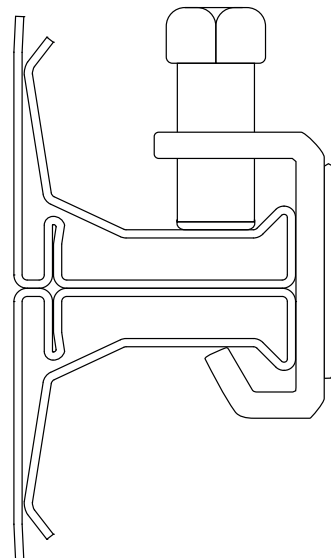

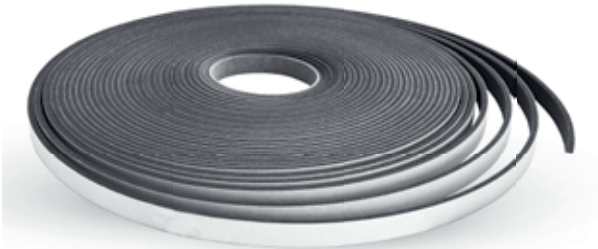

## Dimensions

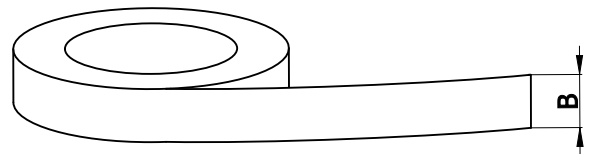

## Description

The DFFF flange foam is made of self-adhesive polyethylene tape. Thermal resistance of the seal is up to 80°C.

DFFF flange foams are applicable for sealing of connections in air conditioning and ventilation ducts.

### Parameters for DFFF:

Diameter of fibre	3,2 µm
Density	200-300 kg/m <sup>3</sup>
Tensile strength	> 350kPa lub 15,4 N/cm
Maximal working temperature	1100°C
Melting point	> 1300 °C
Heat conduction	0,09 W/mK

### Example identification

Product code:           DFFF   -   10   -   4

type   \_\_\_\_\_ |  
width   \_\_\_\_\_ |  
depth  \_\_\_\_\_ |

Code	S [mm]	depth [mm]	length [mb]
DFFF-09-04	9	4	20
DFFF-10-03	10	3	20
DFFF-10-04	10	4	20
DFFF-12-03	12	3	20
DFFF-12-04	12	4	20
DFFF-15-04	15	4	20
DFFF-20-04	20	4	20





## Description

Neutral cure high performing silicone sealant, which adheres without primer on the majority of materials used in building and engineering industry, such as aluminium and steel. Adheres to Galvanised Ducting.

Example identification

Product code:

type

code	volume	material	density	dosage method	thermal resistance	colour	application
SIL-UNI-DF-310	310ml	acetic silicone	1,0 - 1,3 kg/litr	PIS-REC	-40°C do +180 °C	grey	seal stainless steel sheet metal

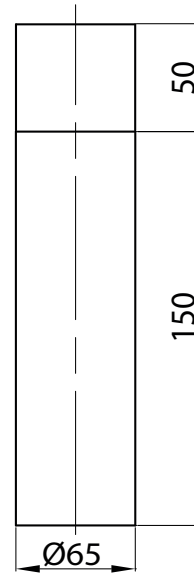

## Description

The DFZS zinc-aluminium spray is designed for a long lasting protection and repair of steel surfaces. It is perfectly adhesive to metals, resistant to water, salt and atmospheric conditions action, as well as high temperature and abrasion.

Technical data:  
temperature range: from -30 °C to +500 °C

Example identification

Product code: \_\_\_\_\_ DFZS

type \_\_\_\_\_



## Description

Steel self-drilling screw WGO for quick mounting of suspension type L, Z and T to the plate. Are also adapted to connect with shaped round duct. WGO screws are available with heads into key-pad or allen. Screws WGO-D thank to their construction allows the fulfillment of tightness class D by Eurovent. Surface is galvanized screws.

There is also the possibility to order overlay for screwdriver into the screw. Below the marks:

WGO-KL-NK - overlay head  
 WGO-KZ-NK - overlay the philips  
 WGO-IB-NK - overlay the allen

Example identification

Product code: **WGO13-KL**  
 type \_\_\_\_\_

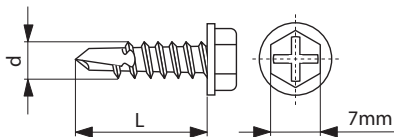

code	Ød [mm]	L [mm]	cap
WGO-D-09	4,2	9	head, philips
WGO-D-13	4,2	13	head, philips

## Dimensions

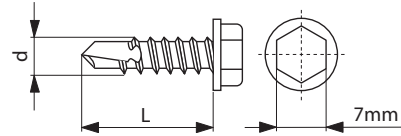

code	Ød [mm]	L [mm]	cap
WGO09-KL	4,2	9	head
WGO13-KL	4,2	13	head
WGO16-KL	4,2	16	head
WGO19-KL	4,2	19	head
WGO25-KL	4,2	25	head

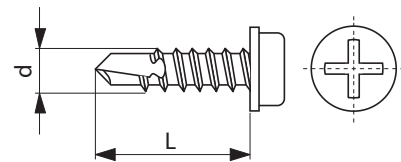

code	Ød [mm]	L [mm]	cap
WGO09-KZ	4,2	9	Philips
WGO13-KZ	4,2	13	Philips
WGO16-KZ	4,2	16	Philips
WGO19-KZ	4,2	19	Philips
WGO25-KZ	4,2	25	Philips

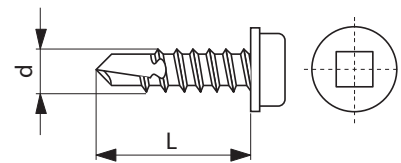

code	Ød [mm]	L [mm]	cap
WGO09-IB	4,2	9	Allen
WGO13-IB	4,2	13	Allen
WGO16-IB	4,2	16	Allen
WGO19-IB	4,2	19	Allen
WGO25-IB	4,2	25	Allen