



Description

The DFKLQ clamp is used to protect rectangular duct connections with joining profile end cover.

Example identification

Product code: DF KLQ-20

type

Dimensions

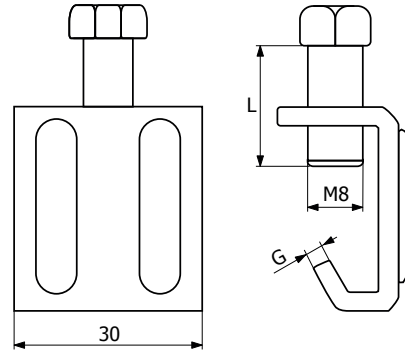

type	screw [mm]	L [mm]	G [mm]
DF KLQ-20	M8	25	3,0
DF KLQ-20-2,5	M8	20	2,5

Connection method

