

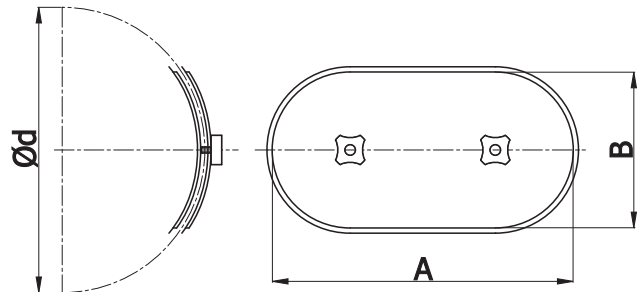

Dimensions



Description

DFCA access door are equipped with CR EPDM gasket and designed for fitting onto round ducts. Its structure, together with adhesive gasket, makes an ideal alignment with a round duct surface. Hence a high class air tightness is guaranteed. It is a simple and effective yet a low cost method for closing inspection openings. Opening sizes are dependent on ducts diameters as per BS 12907 regulation. Another factor influencing an opening size is cleaning method - in some cases even an 800x400mm access door is required. To ensure an easy installation a self – adhesive cut-out template is included. After loosening the knobs, put the inner cover into the duct, adjust position and tighten the knobs.

Available materials:

DFCA-...- galvanized steel

Example identification

Product code: DFCA - aaa

type _____
 Ød _____

Ød nom [mm]	A [mm]	B [mm]	weight [kg]	diameters range
80	180	80	0,3	76 -85
100	180	80	0,3	96-105
125	180	80	0,3	121-130
150	250	150	0,4	130-155
160	250	150	0,4	156-190
200	250	150	0,4	191-240
250	250	150	0,4	241-300
315	250	150	0,4	301-360
355	300	200	0,4	341-380
400	300	200	1,0	381-420
450	300	200	1,0	421-470
500	300	200	1,0	471-530
560	400	300	2,0	531-600
600	400	300	2,0	570-640
630	400	300	2,0	601-670
710	400	300	2,0	671-750
800	400	300	2,0	751-850

* A and B - dimensions of the hole to be cut in the duct